



# Chisago County Environmental Services

313 No. Main St., Room 243  
Center City, MN 55012  
651-213-8370

**To: Applicants for Septic Certifications**  
**From: Chisago County Environmental Services/Zoning**  
**Re: Procedure for Certification/Compliance Inspections**

Follow the checklist below for then instructions to complete a compliance inspection.  
Check list:

- Complete application to the best of your ability.
- Attach a site plan of the property. (See sample drawing page 4).
- Submit application and fee to Chisago County
  - \$200 full system
  - \$100 holding tanks only – for properties without a drainfield
  - Additional \$50.00 fee maybe required if the county has to locate a place to thaw the ground prior to the compliance inspection with the Pumper.
- Hire a maintainer (pumper) to pump your tank. Most maintainers are familiar with this process.  
Maintainer will contact the county for inspection time and date
- Call Gopher State One for locates prior to inspection. 651-454-0002 or 1-800-252-1166
- Uncover ALL 2 foot manhole covers. Pumping must be done through this opening.
- Drain field must be mowed before inspection. If winter conditions are present, the ground will need to be thawed per the instructions attached.

The inspection will be completed by examining the insides of each tank, taking a soil boring within 10 feet of the drain field/mound to ensure adequate separation is present in the soil profile and a visual inspection of the drain field/mound for leakage.

Thank you, and if you have any questions, please feel free to call our office.

Fee for full compliance inspection \$200.00

Fee for holding tanks \$100.00

CHISAGO COUNTY DEPARTMENT OF ENVIRONMENTAL SERVICES/ZONING

REQUEST FOR COMPLIANCE INSPECTION

Reason for compliance request? \_\_\_\_\_ Closing Date \_\_\_\_\_

Property Owner \_\_\_\_\_ Day Phone # \_\_\_\_\_

Site Address \_\_\_\_\_ Fax Results to # \_\_\_\_\_
Address City

Mail results to: \_\_\_\_\_ Tax Parcel Number \_\_\_\_\_
(if different from Name
site address) Address City Zip Township

Or Email: \_\_\_\_\_

Tanks: Sizes Tanks Pumped Yes or No
Septic Tank \_\_\_\_\_ If yes, how often? \_\_\_\_\_
Pump (lift) Tank \_\_\_\_\_
Holding Tank \_\_\_\_\_ Year house purchased? \_\_\_\_\_
Aerobic Tank \_\_\_\_\_ Year septic system built? \_\_\_\_\_

Distance from: Is the system currently being used? Yes or No
Tank to well? \_\_\_\_\_ Ft Drainfield to well? \_\_\_\_\_ Ft Depth of well(s)? \_\_\_\_\_ Ft

Soil Treatment System:
Trenches Mound At grade Other: (identify Type) \_\_\_\_\_
Pressure bed Chambers Alternative system

Any repair done on system? Yes or No If yes, what? \_\_\_\_\_

When? \_\_\_\_\_ By whom? \_\_\_\_\_

Number of bedrooms \_\_\_\_\_ Nearest surface water: \_\_\_\_\_ ft

Number of occupants \_\_\_\_\_ From which type of surface water?
River Lake Stream Other \_\_\_\_\_

Was an Operating permit required for this septic system? Yes or No Name of water source \_\_\_\_\_

Is there or has there ever been any evidence of:

Discharge of sewage to the ground surface? Yes or No A seepage pit, drywell, cesspool or leaching pit? Yes or No

Discharge of sewage to a surface water? Yes or No

Sewage backup into dwelling or other establishment presently occurring? Yes or No

Explain

Situations with the potential to immediately and adversely impact or threaten public health or safety? Yes or No

Explain: \_\_\_\_\_

Signature of Applicant \_\_\_\_\_

Date \_\_\_\_\_



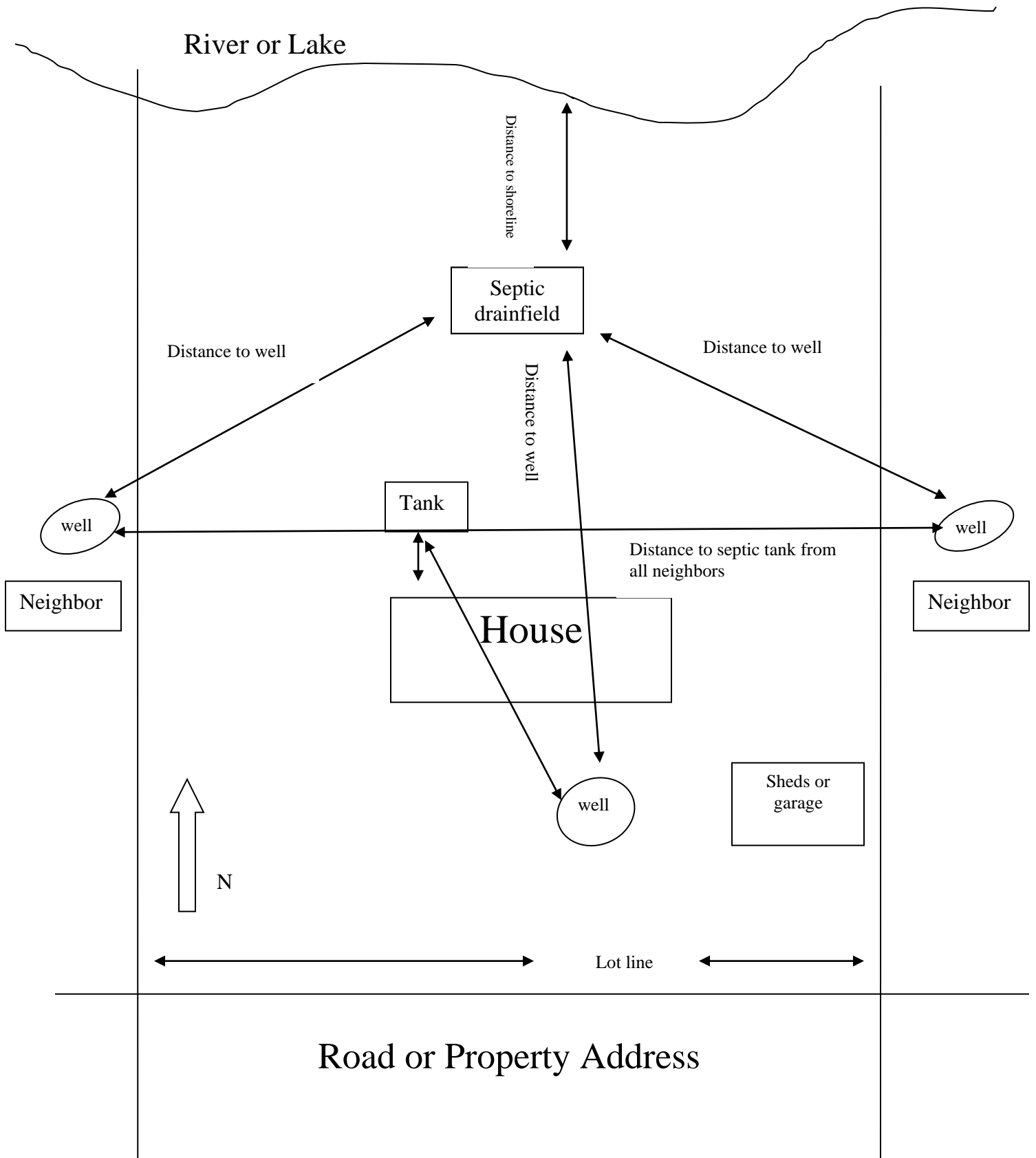

**Please draw the above information (as it relates) on a separate sheet of paper – This is for reference only.**

<b>License # Business Name</b>	<b>Contact Info</b>	<b>Specialty Areas</b>
<b>L2425</b> Boettcher Excavating & Septic	28995 Jodrell Dr NE Cambridge, MN 55008 <b>763-444-4930</b>	Maintainer
<b>L3287</b> Hassel Free Septic	PO Box 702 North Branch, MN 55056 <b>763-222-4397</b>	Maintainer
<b>L1837</b> Maple Ridge Sewer Service, Inc	PO Box 72 Cambridge, MN 55008 <b>763-689-6803</b>	Maintainer
<b>L930</b> Northside Septic	1301 245 <sup>th</sup> Ave NE Bethel, MN 55005 <b>763-444-7898</b>	Maintainer
<b>L216</b> Olson's Sewer Service, Inc	17638 Lyons St NE Forest Lake, MN 55025 <b>651-464-2082</b>	Maintainer
<b>L3070</b> R & M Septic Service	37654 Falcon Ave North Branch, MN 55056 <b>651-674-8520</b>	Maintainer
<b>L3448</b> Ross' Sewer Service, Inc.	9288 County Road 5 NE North Branch, MN 55056 <b>651-674-4349</b>	Maintainer
<b>L3309</b> Rowe Sewer	PO Box 236 412 Bench Street Taylors Falls, MN 55084 <b>651-465-6841</b>	Maintainer
<b>L2428</b> Smiles's Sewer Service	PO Box 100 Scandia, MN <b>651-433-3005</b>	Maintainer
<b>L2624</b> Septic Check, Inc.	6074 Keystone Rd Milaca, MN 56353 <b>320-983-24470</b>	Maintainer
<b>L261</b> Thompson Sewer Service & Soil Testing	49861 Government Rd Rush City, MN 55069 <b>320-358-9941</b>	Maintainer